

## Important note:

Before using the app, it is necessary to establish a BT connection between your mobile device and GZDSP BT-STICK/GZDSP BTS 4-8XII as usual !  
After that, the features of the app will be available.

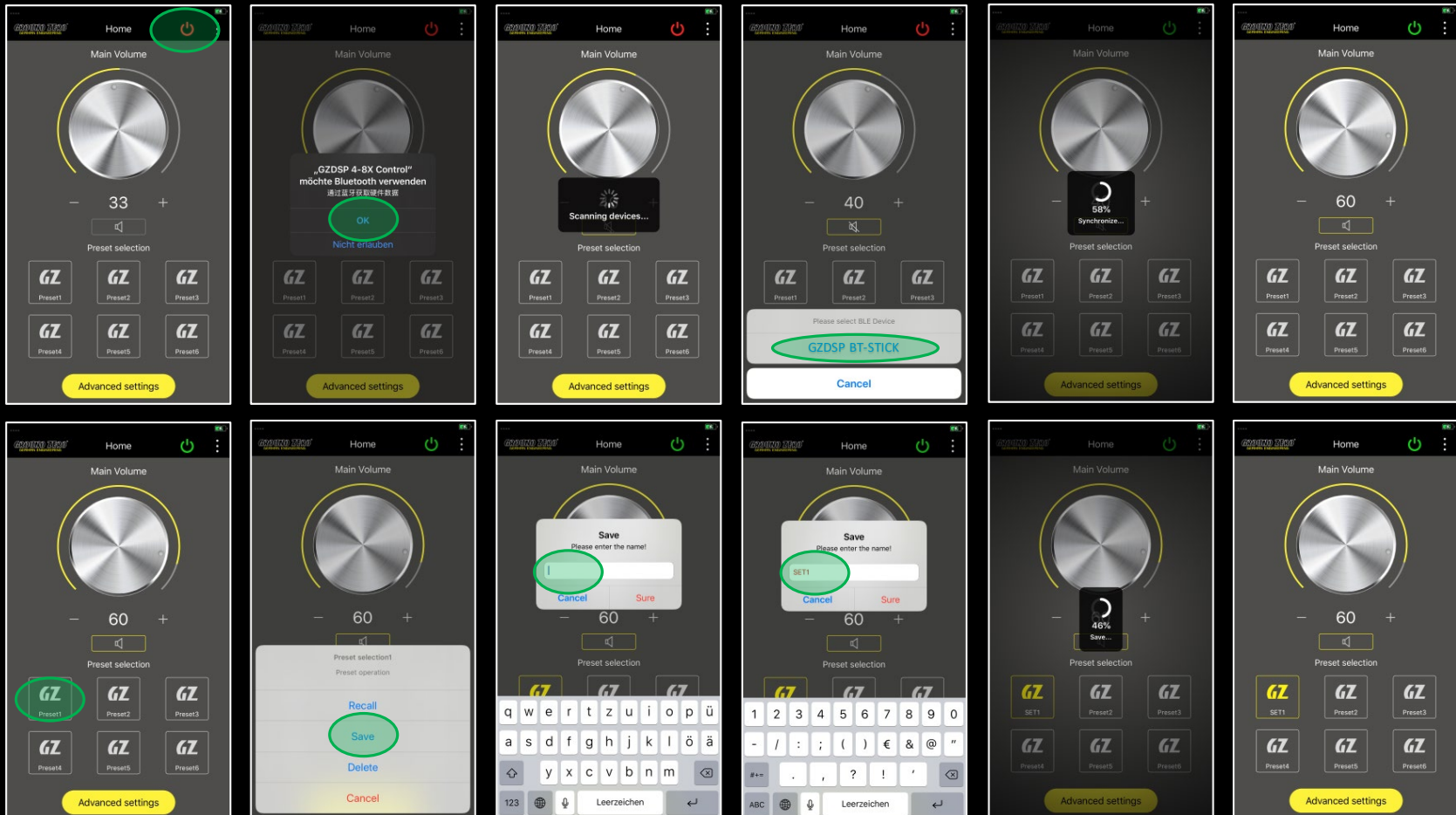

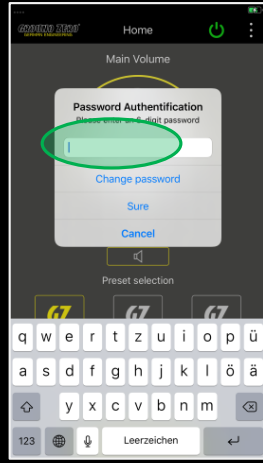
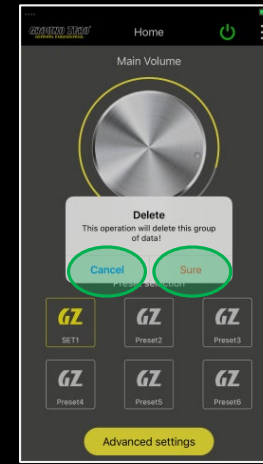
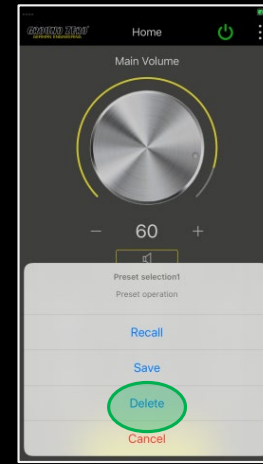
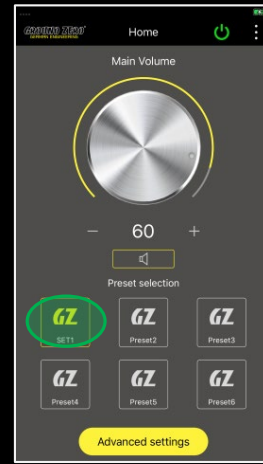
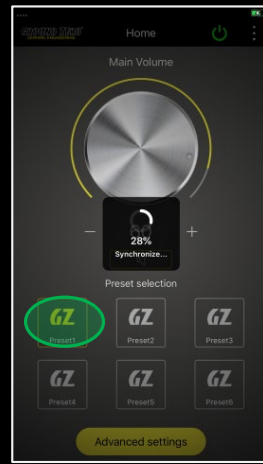
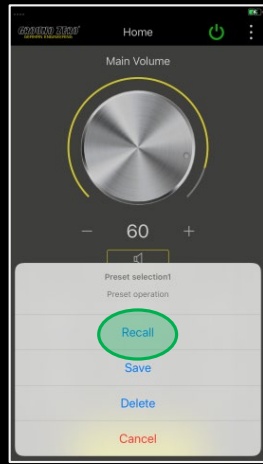
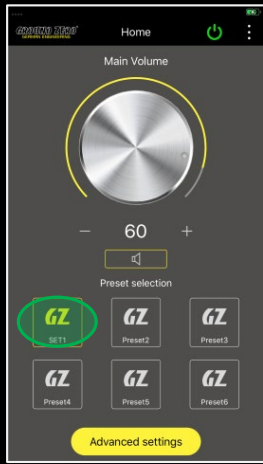

Note:  
factory set  
password  
  
666666

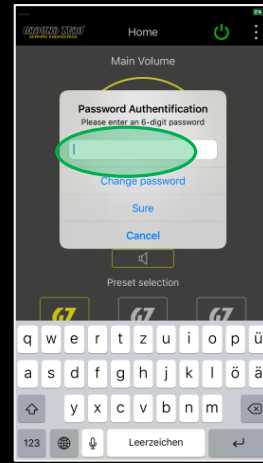
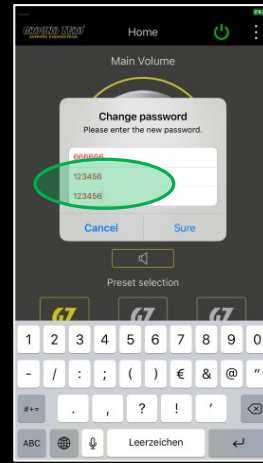
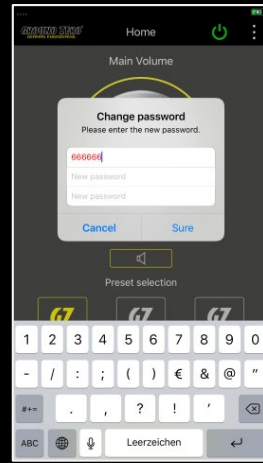
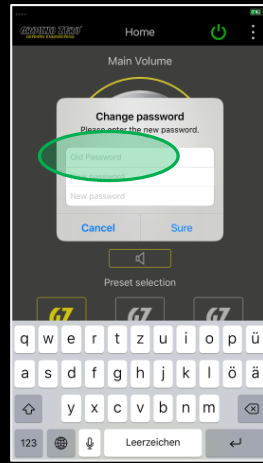
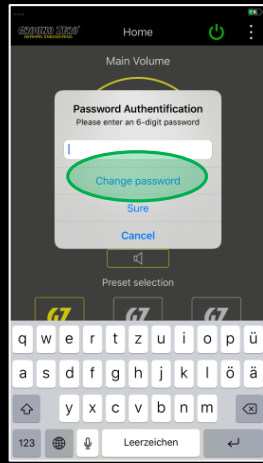
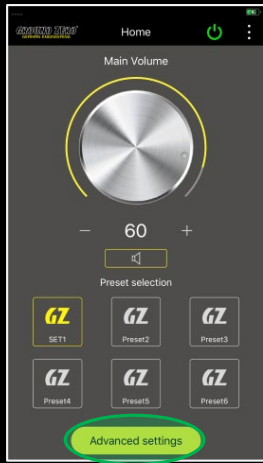
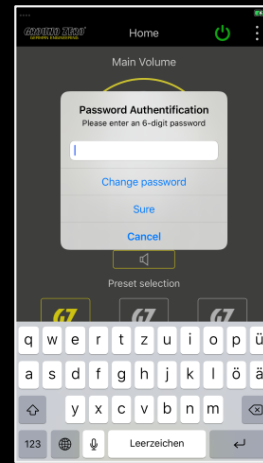
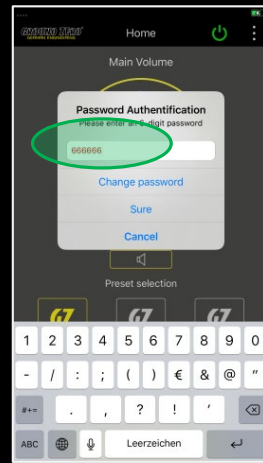

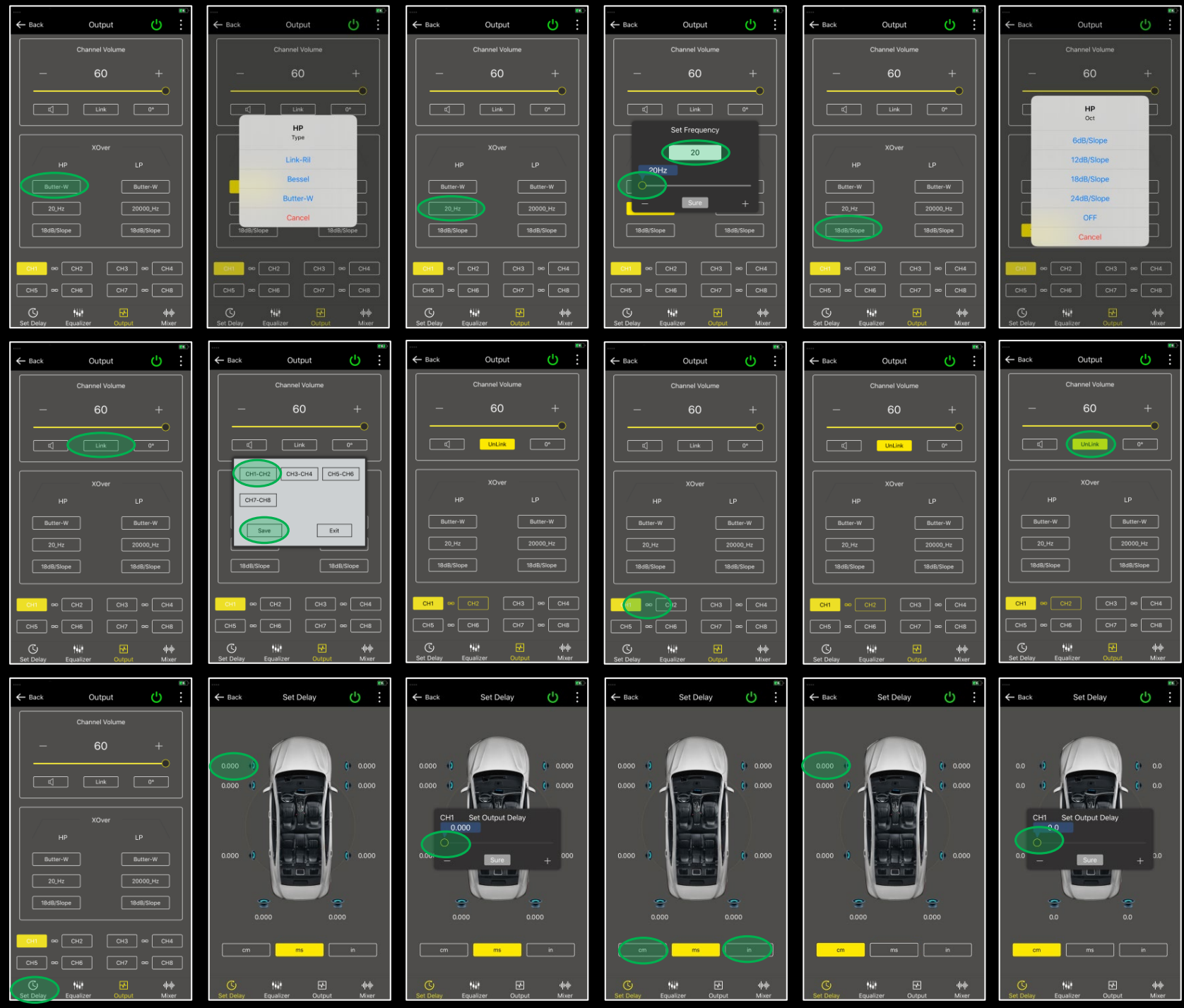

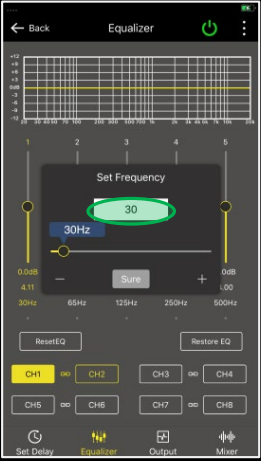
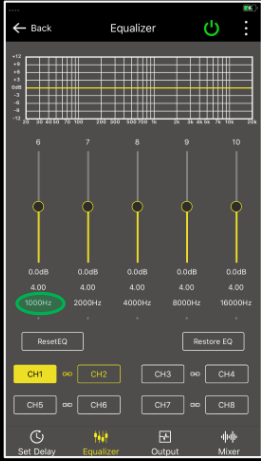
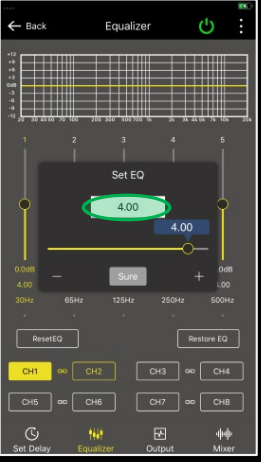
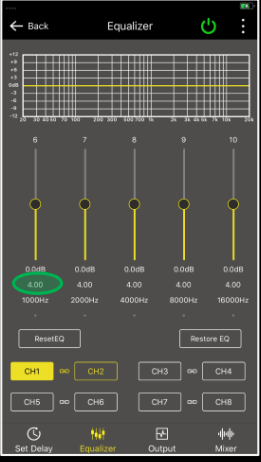
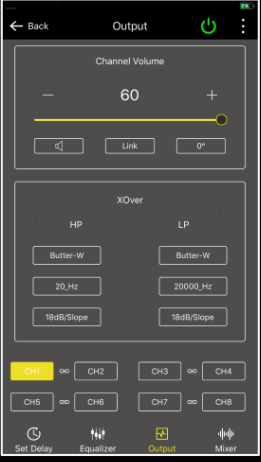
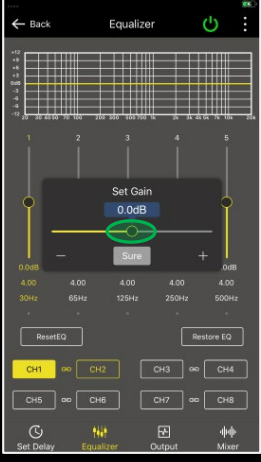
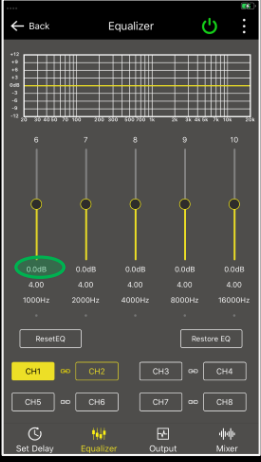

**Note:**  
Slide to display more EQ bands

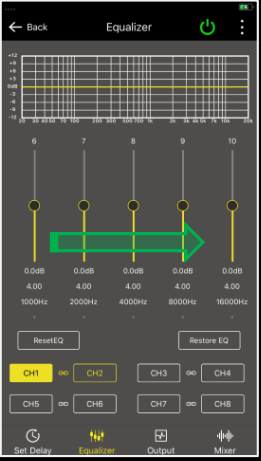
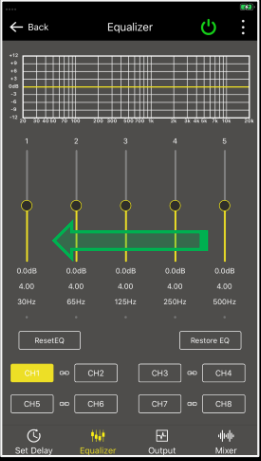

**Note:**  
Select the required input channel(s)

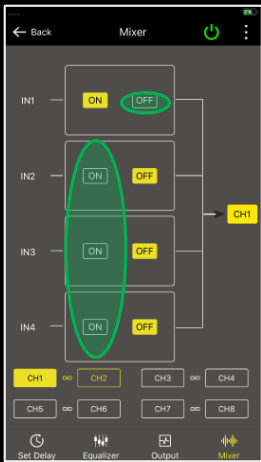

**Note:**  
Find the app version

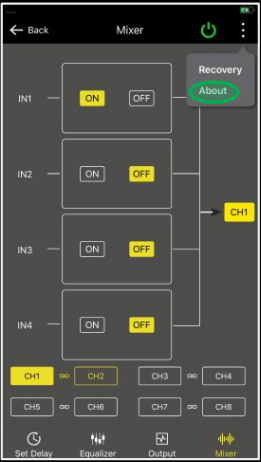

**Note:**  
Factory Reset

